

**COUNTY OF LOS ANGELES**  
**ROAD DEPARTMENT**

**PRECISE**  
**BENCH MARK LIST**



**SAN DIMAS QUAD**  
**1965 ADJUSTMENT**

## PREFACE

The Road Department level net is composed of more than 1,000 miles of levels supporting in excess of 10,000 bench marks. In 1964-65, a major readjustment of the net was undertaken. To emphasize the complete break with previous elevations, the SY, SG & SL series bench marks have been re-labeled BY, BG & BL, respectively.

To facilitate the adjustment, indexing, and distribution of adjusted values of the net, the County territory was divided into 31 quads or areas. For identification purposes each quad was given a name, viz., "Rosemead," "La Mirada," "Santa Fe," etc. When bench marks and elevations in the Road Department net are used, the name of the quad in which the bench mark is located and the date of the adjustment of the elevation must be included in the bench mark description, e.g.,

BG 1887 --L+BN IN CONC HDWL OF DRAIN PIPE UNDER DR 218 FT  
NE +18 FT SE C/L INT GRAND AVE +CAMERON AVE MKD (BM)  
(COVINA --1965) ELEV. 696.238

It is expected that this general adjustment will, for the most part, remain sound for the next 8 to 12 years. As new circuits are completed, however, re-adjustment of individual quads may become advisable. It is expected that these subsequent adjustments will be in the nature of a few hundredths of a foot. When a quad is re-adjusted, new elevation lists will be published and the date of the re-adjustment will replace the "1965" at the end of the bench mark description. Two bench marks in the same quad with different adjustment dates will not normally join each other. Since all adjustments taper out to nothing at the periphery of the quad, any bench mark in one quad will join any bench mark in another quad regardless of their respective adjustment dates.

The basic accuracy of the net is reflected by an indicated field probable error of plus or minus 0.012 foot per mile of leveling as determined from 298 conditions of closure. However, many years experience in vertical control in the greater Los Angeles basin and Antelope Valley indicate that because of varying degrees of subsidence and heaving, the true datum is recovered only by obtaining substantial agreement of a number of bench marks.

The users of this net are invited to assist in its maintenance by notifying this Department of cases of obliteration, apparent mistakes in descriptions or elevations, and proven disturbance of bench marks.

---

DATUM: U. S. Coast and Geodetic Survey Sea Level Datum  
of 1929, through the medium of the Los Angeles  
County Engineer Precise Level Net, 1963 Adjust-  
ment.

ABBREVIATIONS USED IN BENCH MARK LISTINGS

ABUT - - - - -	Abutment	EC - - - - -	End of Curve
ALG - - - - -	Along	ENT - - - - -	Entrance
ANG PT - - - - -	Angle Point	FL - - - - -	Floor
B/W - - - - -	Back of Walk	FTG - - - - -	Footing
BCR - - - - -	Beginning of Curb Return	F/W - - - - -	Front of Walk
BC - - - - -	Beginning of Curve	GAR - - - - -	Garage
BLDG - - - - -	Building	HDWL - - - - -	Headwall
BM - - - - -	Bench Mark	HSE - - - - -	House
BT SPK - - - - -	Boat or Bolt Spike	INT - - - - -	Intersection
BR CAP - - - - -	Brass or Bronze Cap	IP - - - - -	Iron Pipe
C B - - - - -	Catch Basin	LT - - - - -	Left
CTR - - - - -	Center	LACE - - - - -	L. A. City Engineer
C/L - - - - -	Center Line	LACS - - - - -	L. A. County Engineer
C/L INT - - - - -	Center Line Intersection	LAFC - - - - -	L. A. Co. Flood Control
C/L PROD - - - - -	Center Line Produced	L+BN - - - - -	Lead and Bench Nail
CONC - - - - -	Concrete	L+BR - - - - -	Lead and Brad
COR - - - - -	Corner	L+N - - - - -	Lead and Nail
COE - - - - -	Corps of Engineers	L+RDBM TAG - - - - -	Lead and Road Dept. Bench Mark Tag
CULV - - - - -	Culvert	L+SPK - - - - -	Lead and Spike
CB - - - - -	Curb	L+T - - - - -	Lead and Tack
CS MON - - - - -	County Engineer Monument	MCR - - - - -	Middle of Curb Return
CS BR CAP - - - - -	County Engineer Brass Cap	MKD - - - - -	Marked
CT SPK - - - - -	Cut Spike	MC - - - - -	Middle of Curve
DR - - - - -	Drive or Driveway	MON - - - - -	Monument
E/O - - - - -	East of	N/O - - - - -	North of
ECR - - - - -	End of Curb Return	NR - - - - -	Near

ABBREVIATIONS USED IN BENCH MARK LISTINGS \* \* \* CONTINUED

OPP - - - - - Opposite  
PI - - - - - Point of Intersection  
PK+W - - - - - PK Nail and Washer  
P/L - - - - - Property Line  
POST - - - - - Point on Semi-Tangent  
PP - - - - - Power Pole  
PVMT - - - - - Pavement  
PROD - - - - - Produced  
RD - - - - - Road  
RDBM - - - - - Road Dept. Bench Mark  
RR - - - - - Railroad  
RT - - - - - Right  
R/W - - - - - Right of Way  
SDMH - - - - - Storm Drain Manhole  
SMH - - - - - Sewer Manhole  
SPK - - - - - Spike  
ST+W - - - - - Spike Tin and Washer  
S/O - - - - - South of  
TP - - - - - Telephone Pole  
USC+GS - - - - - U. S. Coast and Geodetic Survey  
USGS - - - - - U. S. Geological Survey  
WK - - - - - Walk  
W/O - - - - - West of

COVINA QUAD

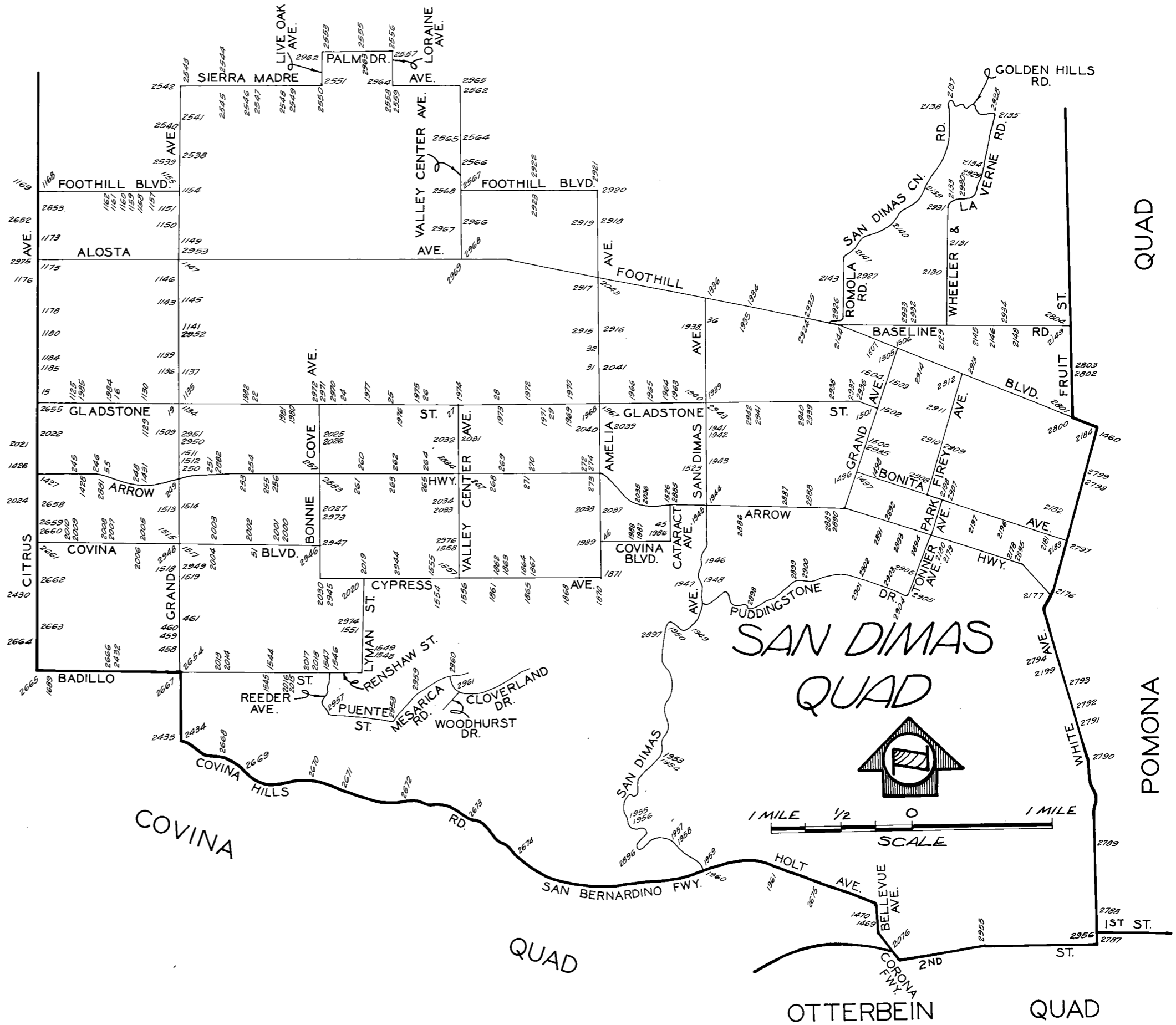

QUAD

POMONA

OTTERBEIN QUAD

QUAD-YEAR	ELEV	DESCRIPTION (INCLUDE QUAD AND YEAR IN DESCRIPTION)	BM	NUMBER
BASELINE (1965)	587.368	DISC TOP OF CONC POST 1FT DN UNDER CS CASTIRON CAP 65FT E + 12FT N C/L INT CYPRESS AVE + GLADSTONE ST	BG	15
SN DIMAS (1965)	623.515	L+N IN WALL ON E SIDE BEN LOMOND AVE 35FT S C/L GLADSTONE ST	BG	16
SN DIMAS (1965)	759.602	USC+GS MON 10IN DN 11FT N +750FT E C/L INT GLADSTONE ST + BONNIE COVE AVE MKD (GLADSTONE 1923 RESET 1956 RE 5869)	BG	24
SN DIMAS (1965)	792.023	L+T N CB GLADSTONE ST NR C/L PROD SUNFLOWER AVE	BG	25
SN DIMAS (1965)	812.259	L+T N CB 28FT N + 270FT E C/L INT GLADSTONE ST + BRADFORD DR	BG	26
SN DIMAS (1965)	829.673	L+T S CB GLADSTONE ST 1FT W BCR @ SW COR VALLEY CENTER AVE 49FT W + 28FT S C/L INT	BG	27
SN DIMAS (1965)	854.592	L+T N CB GLADSTONE ST 50FT E PP NO 439596 IN FRONT HSE NO 124	BG	28
SN DIMAS (1965)	888.917	USC+GS DISC IN CULV HDWL 42FT S C/L GLADSTONE ST 25FT E C/L SFRR MKD (C96 1931)	BG	29
SN DIMAS (1965)	924.935	L+N S E COR BASE STANLEY 28FT N C/L ALLEN AVE + 30FT W C/L AMELIA AVE	BG	31
SN DIMAS (1965)	928.008	L+N SE COR OF CONC BASE TRANSMISSION TOWER NO 235 D7 60FT W C/L AMELIA AVE	BG	32
SN DIMAS (1965)	998.294	DISC IN CONC POST 20FT E C/L SAN DIMAS AVE + 200FT N C/L BASE LINE RD MKD (Y35 1923 RESET 1934)	BG	36
SN DIMAS (1965)	907.380	L+T IN CONC DR TO HSE @ NW COR COVINA BLVD + CATARACT AVE 132FT N + 35FT W C/L INT MKD (BM)	BG	45
SN DIMAS (1965)	847.084	L+N IN N EDGE GUTTER 20FT N C/L COVINA BLVD + 3FT E C/L AMELIA AVE	BG	46
SN DIMAS (1965)	673.285	L+T NR CTR CB RET @ SE COR GLENDORA AVE + COVINA BLVD 22FT S + 22FT E C/L INT	BG	51
BASELINE (1965)	564.340	BT SPK E CB 5FT S BCR @ SE COR CYPRESS AVE + CYPRESS ST 62FT S + 30FT E C/L INT MKD (SD 137)	BG	64
SN DIMAS (1965)	597.656	L+T S CB N SERVICE RD ARROW HWY ON C/L PROD FAIRVALLEY AVE	BG	245
SN DIMAS (1965)	603.696	L+T S CB N SERVICE RD ARROW HWY ON C/L PROD OAKBANK DR	BG	246
SN DIMAS (1965)	630.331	FC BR MON FLUSH IN DR 50FT N C/L ARROW HWY ON R/W OF SAN DIMAS WASH 25FT N OF E END BRIDGE + 1400FT E BEN LOMOND AVE MKD (RW 87)	BG	248
SN DIMAS (1965)	655.555	RD MON IN WELL 8IN DN @ OR NR C/L INT ARROW HWY + GRAND AVE MKD (LA CO RD DEPT 1960)	BG	249
SN DIMAS (1965)	652.774	FC MON 2IN DN ON NE COR ARROW HWY + GRAND AVE 110FT N + 59FT E C/L INT MKD (88 RW6)	BG	250
SN DIMAS (1965)	679.870	L+T IN CONC WK TO HSE W/CONC BLOCK FENCE 66FT N C/L ARROW HWY 900FT W GLENDORA AVE MKD (BM)	BG	251

QUAD-YEAR	ELEV	DESCRIPTION (INCLUDE QUAD AND YEAR IN DESCRIPTION)	BM	NUMBER
SN DIMAS (1965)	692.383	RDBM TAG S CB 1FT W BCR @ SW COR ARROW HWY + GLENDDORA AVE 42FT S + 71FT W C/L INT	BG	253
SN DIMAS (1965)	695.407	RDBM TAG N CB 6FT W BCR @ NE COR ARROW HWY + GLENDDORA AVE 42FT N + 61FT E C/L INT	BG	254
SN DIMAS (1965)	704.214	L+T IN E END OF CONC WK 53FT S C/L ARROW HWY FRONT OF HSE NO 20058	BG	255
SN DIMAS (1965)	710.310	L+BN IN E EDGE CONC WK 8FT FROM N END WK 55FT S C/L ARROW HWY FRONT OF HSE NO 20144 375FT W C/L BANNING AVE	BG	256
SN DIMAS (1965)	730.902	RD MON IN WELL 8IN DN @ DR NR C/L INT BONNIE COVE AVE + ARROW HWY MKD (LA CO RD DEPT)	BG	257
SN DIMAS (1965)	752.078	L+T N CB 42FT N C/L ARROW HWY ON C/L PROD LYMAN AVE MKD (BM)	BG	260
SN DIMAS (1965)	751.676	RD MON IN WELL 8IN DN @ DR NR C/L INT ARROW HWY + LYMAN AVE MKD (LA CO RD DEPT 1960)	BG	261
SN DIMAS (1965)	771.965	L+T E SIDE OF DOOR OF BRICK BLDG 70FT N C/L ARROW HWY @ NE COR SUNFLOWER AVE	BG	262
SN DIMAS (1965)	769.757	RD MON IN WELL 8IN DN @ DR NR C/L INT ARROW HWY + SUNFLOWER AVE MKD (LA CO RD DEPT 1960)	BG	263
SN DIMAS (1965)	796.099	RDBM TAG IN N CB 42FT N C/L ARROW HWY + 1000FT W VALLEY CENTER AVE	BG	264
SN DIMAS (1965)	795.489	RDBM TAG IN S CB 42FT S C/L ARROW HWY + 1000FT W VALLEY CENTER AVE	BG	265
SN DIMAS (1965)	810.574	L+T IN S CB 42FT S C/L ARROW HWY + 68FT E C/L VALLEY CENTER AVE MKD (BM)	BG	267
SN DIMAS (1965)	840.634	L+T CONC COVERED ROCK WALL (BROKEN) 70FT S C/L ARROW HWY RT OF DR TO HSE NO 1312	BG	268
SN DIMAS (1965)	839.522	RDBM TAG N CB 42FT N C/L ARROW HWY + 1000FT E VALLEY CENTER AVE	BG	269
SN DIMAS (1965)	859.722	RD MON IN WELL 8IN DN @ DR NR C/L INT ARROW HWY + LONE HILL AVE MKD (LA CO RD DEPT 1960)	BG	270
SN DIMAS (1965)	861.041	L+T IN S CB @ SW COR ARROW HWY + LONE HILL AVE 80FT W + 42FT S C/L INT MKD (BM)	BG	271
SN DIMAS (1965)	887.750	L+BN IN TOP OF 8IN STANDPIPE 78FT N C/L ARROW HWY 380FT W OF BC W OF AMELIA AVE	BG	272
SN DIMAS (1965)	890.730	L+T IN S CB ARROW HWY 42FT S C/L + 50FT W OF BC W OF AMELIA AVE MKD (BM)	BG	273
SN DIMAS (1965)	892.047	RDBM TAG 42FT N C/L ARROW HWY + 7FT W OF BC W OF AMELIA AVE	BG	274
SN DIMAS (1965)	590.665	L+BN W CB 1FT N BCR @ COR ADAMS PARK DR + GRAND AVE	BG	458
SN DIMAS (1965)	605.683	L+BN @ W BCR @ NW COR GRAND AVE + RUDDOCK AVE	BG	459
SN DIMAS (1965)	619.226	L+BRAD E CB 3FT S BCR @ NE COR EDGECOMB ST + GRAND AVE	BG	460
SN DIMAS (1965)	618.968	L+BN IN CTR E CONC HWY OF BRIDGE NO 131 ON GRAND AVE 155FT N COR IN BERNARDINO RD	BG	461

QUAD-YEAR	ELEV	DESCRIPTION (INCLUDE QUAD AND YEAR IN DESCRIPTION)	BM NUMBER
SN DIMAS (1965)	613.535	L+T CONC BASE S LEG OF HIGH TENSION TOWER NO 239D5 310FT E DR TO HSE NO 18725 GLADSTONE ST 75FT N C/L + 50FT W BIG DALTON WASH	BG 1125
SN DIMAS (1965)	634.011	CS MON IN WELL 10 IN DN C/L GLADSTONE ST 215FT W C/L SODERBERG AVE	BG 1129
SN DIMAS (1965)	637.807	L+T CTR CB RET @ NW COR SODERBERG AVE + GLADSTONE ST	BG 1130
SN DIMAS (1965)	666.048	L+T W CB GRAND AVE 45 FT N DR TO HSE NO 5733 100FT S C/L PROD DAWSON AVE	BG 1136
SN DIMAS (1965)	666.308	L+SPK S CB DAWSON AVE 10FT E BCR @ SE COR GRAND AVE 20FT S + 76FT E C/L INT MKD (SD 301)	BG 1137
SN DIMAS (1965)	663.854	L+BN CONC BASE OF SE LEG OF HIGH TENSION TOWER NO 238 D6 130FT N BIG DALTON WASH + 70FT W C/L GRAND AVE	BG 1139
SN DIMAS (1965)	672.243	PK IN N CB BASE LN RD 2FT E BCR @ NE COR GRAND AVE 30FT N 100FT E C/L INT MKD (SD 304)	BG 1141
SN DIMAS (1965)	686.500	L+T S EDGE CONC WK TO HSE NO 6159 65FT W C/L GRAND AVE @ SW COR MAUNA LOA AVE	BG 1143
SN DIMAS (1965)	689.440	L+SPK S CB MAUNA LOA AVE 5FT E BCR @ SE COR GRAND AVE 18FT S + 83FT E C/L INT	BG 1145
SN DIMAS (1965)	691.995	L+T SE COR WEIR BOX 30 FT W C/L GRAND AVE + 15FT S C/L PROD COLORADO AVE	BG 1146
SN DIMAS (1965)	701.643	L+T W END OF GAS STA ISL 65FT S C/L ALOSTA AVE + 70FT E C/L GRAND AVE	BG 1147
SN DIMAS (1965)	705.716	L+BN 1FT N BCR OF SERVICE RD @ NE COR 52FT W C/L GRAND AVE + 38FT W C/L ORANGEPATH ST	BG 1149
SN DIMAS (1965)	711.119	L+T 1FT S BCR @ SW COR SERVICE RD 48FT S C/L HEBER ST + 81FT W C/L GRAND AVE	BG 1150
SN DIMAS (1965)	716.943	L+T 1FT S BCR @ SW COR GRAND AVE SERVICE RD + LOCHLEVEN ST	BG 1151
SN DIMAS (1965)	725.465	CS MON @ C/L INT FOOTHILL BLVD GRAND AVE (USE N EDGE)	BG 1154
SN DIMAS (1965)	722.055	COE STD BR CAP MON N CB FOOTBLVD 17FT W OF END CB 30FT N + 136FT W C/L INT GRAND AVE MKD (LD17-1957)	BG 1155
SN DIMAS (1965)	699.231	L+BN 1FT W BCR @ NW COR VALENTIA ST + FOOTHILL BLVD	BG 1157
SN DIMAS (1965)	692.984	L+T E CB WILDWOOD AVE 47FT S C/L FOOTHILL BLVD	BG 1158
SN DIMAS (1965)	687.384	L+T E CB CALIFORNIA AVE 55FT S C/L FOOTHILL BLVD	BG 1159
SN DIMAS (1965)	681.694	L+T W CB MARIETTA AVE 45FT S C/L FOOTHILL BLVD	BG 1160
SN DIMAS (1965)	676.147	L+T W CB BELMONT AVE 100FT S C/L FOOTHILL BLVD	BG 1161
SN DIMAS (1965)	676.502	CS MON @ C/L INT <del>LE</del> LOMOND AVE + FOOTHILL BLVD	BG 1162



QUAD-YEAR	ELEV	DESCRIPTION (INCLUDE QUAD AND YEAR IN DESCRIPTION)	BM NUMBER
BASELINE (1965)	655.439	CS MON @ C/L INT FOOTHILL BLVD TO E + CITRUS AVE S	BG 1168
BASELINE (1965)	655.924	L+T E WALL OF DRAIN 30FT N C/L FOOTHILL BLVD TO E 17FT W C/L PROD CITRUS AVE 25FT N DR TO HSE NO 6843	BG 1169
BASELINE (1965)	626.216	FC BR CAP W RET WALL 75FT N LITTLE DALTON WASH + 18FT W C/L CITRUS AVE	BG 1173
BASELINE (1965)	616.107	L+BN N CB ALOSTA AVE 33FT W BCR @ NW COR CITRUS AVE 100FT W + 40FT N C/L INT	BG 1175
BASELINE (1965)	616.544	L+SPK E CB CITRUS AVE 10FT S BCR @ SE COR ALOSTA AVE 30FT E + 104FT S C/L INT	BG 1176
BASELINE (1965)	609.285	RDBM TAG N CB MAUNA LOA AVE 6FT E BCR @ NE COR CITRUS AVE 18FT N + 72FT E C/L INT	BG 1178
BASELINE (1965)	599.439	L+BN E CB CITRUS AVE 23FT S BCR @ SE COR BASE LINE RD + 87FT S C/L INT	BG 1180
BASELINE (1965)	591.844	L+T N CB NEARFIELD ST 5FT E BCR @ NE COR CITRUS AVE 70FT E + 100FT N C/L INT	BG 1184
BASELINE (1965)	591.704	L+BRAD S CB NEARFIELD ST 1FT E BCR @ SE COR CITRUS AVE 64FT E + 18FT S C/L INT	BG 1185
BASELINE (1965)	578.138	C S MON @ C/L CITRUS AVE 20FT S C/L ARROW HWY MKD (SEC COR 2 1 11 12 T1S R10W)	BG 1426
BASELINE (1965)	580.676	L+T SIDE CONC BASE OF LIGHT STANDARD 50FT N C/L ARROW HWY + 54FT E C/L CITRUS AVE	BG 1427
SN DIMAS (1965)	597.052	L+BN CTR CB RET @ SE COR FAIRVALLEY AVE + ARROW HWY SERV RD	BG 1428
SN DIMAS (1965)	631.464	L+BN W END GAS PUMP ISLAND OF BLDG NO 19131 ARROW HWY 175FT N C/L + 25FT E C/L BEN LOMOND AVE	BG 1431
BASELINE (1965)	1150.342	CS MON SE COR WHITE AVE + FOOTHILL BLVD 15FT E + 51FT S C/L INT	BG 1460
BASELINE (1965)	785.441	BRONZE DISK IN CTR OF CONC ABUT OF SPRR CULV 8FT N OF TRACKS 250FT W INT VERNON AVE + BELLEVUE AVE	BG 1469
BASELINE (1965)	794.707	L+T CTR OF S CB RET @ INT OF BELLEVUE HWY OF CORONA FRWY	BG 1470
SN DIMAS (1965)	1049.369	L+BN S CB 2FT W C/L GRAND AVE + 35FT S C/L BONITA AVE + 40FT	BG 1496
SN DIMAS (1965)	1048.748	L+BN E CB GRAND AVE 20FT E C/L + 100FT S C/L BONITA AVE	BG 1497
SN DIMAS (1965)	1033.083	CS MON IN WELL 9IN DN 8FT N OF N CB PROD BONITA AVE + 31FT E OF E CB PROD GLENFIELD AVE MKD (BM 13-14 1952 RE63)	BG 1498
SN DIMAS (1965)	1061.111	L+BRAD 1FT N BCR @ NW COR JUANITA AVE + GRAND AVE	BG 1500
SN DIMAS (1965)	1071.741	L+BN W CB GRAND AVE 15FT W C/L + 55FT S C/L GLADSTONE ST	BG 1501
SN DIMAS (1965)	1072.307	CS MON IN WELL @ C/L INT GLADSTONE ST + GRAND AVE	BG 1502

QUAD-YEAR	ELEV	DESCRIPTION (INCLUDE QUAD AND YEAR IN DESCRIPTION)	BM NUMBER
SN DIMAS (1965)	1095.456	L+BN IN CONC SLAB @ THE SE COR OF A BARN 35FT W C/L GRAND AVE OPP HSE NO 860 1000 FT N C/L GLADSTONE ST	BG 1503
SN DIMAS (1965)	1096.807	L+T IN SE COR OF CONC WK TO HSE NO 906 GRAND AVE 50FT E C/L + 1000 FT N C/L GLADSTONE ST	BG 1504
SN DIMAS (1965)	1123.408	L+BN S CB 21FT W BCR @ NW COR GRAND AVE + FOOTHILL BLVD	BG 1505
SN DIMAS (1965)	1123.635	L+T N CB FOOTHILL BLVD 36FT W C/L INT PROD GRAND AVE	BG 1506
SN DIMAS (1965)	1132.417	CS MON IN WELL 5FT W C/L INT BONNELLE AVE + 5FT E C/L BASE LINE RD MKD (BM 11-51 1952 RE 63)	BG 1507
SN DIMAS (1965)	658.954	L+BN 1FT N OF SE COR OF CB AROUND OAKDALE CEMETERY 33FT N + 36FT W C/L INT GRAND AVE + JUANITA AVE	BG 1509
SN DIMAS (1965)	658.355	RDBM TAG IN N CB 15FT E OF BCR 30FT E + 18FT N C/L INT GRAND AVE + FLEETWOOD PL	BG 1511
SN DIMAS (1965)	657.370	L+BN IN E CB 3FT S BCR 58FT S + 40FT E C/L INT GRAND AVE + FLEETWOOD PL	BG 1512
SN DIMAS (1965)	646.223	CS MON IN WELL 8 IN DN @ C/L INT GRAND AVE + CIENEGA AVE MKD (RE 03) USE S EDGE	BG 1513
SN DIMAS (1965)	647.573	RDBM TAG E CB 1FT N BCR @ NW COR GRAND AVE + CIENEGA AVE 66FT N + 40FT W C/L INT	BG 1514
SN DIMAS (1965)	637.349	RDBM TAG 2FT N BCR @ NW COR COVINA BLVD + GRAND AVE 67FT N + 40FT W C/L INT	BG 1515
SN DIMAS (1965)	632.984	L+BN W CB GRAND AVE 45FT N C/L + 550FT S COVINA BLVD OPP GARAGE TO HSE NO 4708	BG 1517
SN DIMAS (1965)	627.099	F C MON 7IN DN @ C/L INT GRAND AVE + CYPRESS ST MKD (RESET 12-62)	BG 1518
SN DIMAS (1965)	623.305	NAIL IN CHIS (X) N CB HURST ST 18FT N C/L + 80FT W C/L GRAND AVE	BG 1519
SN DIMAS (1965)	951.983	CS MON IN WELL @ C/L INT OF BONITA AVE + SAN DIMAS AVE	BG 1523
SN DIMAS (1965)	921.028	L+BN W CB CATARACT AVE 20FT W C/L + 185FT N C/L ARROW HWY	BG 1526
SN DIMAS (1965)	679.459	CS MON IN WELL 15IN DN @ C/L INT BADILLO ST + REEDER ST (USE NE COR)	BG 1546
SN DIMAS (1965)	680.257	RDBM TAG IN W CB 2FT N BCR @ NW COR REEDER ST + BADILLO ST 18FT W + 51FT N C/L INT	BG 1547
SN DIMAS (1965)	696.971	1-1/2IN IP RE TAG 2699 4IN DN @ INT P/L OF 4034 + 4040 LYMAN AVE 30FT E + 200FT N OF CURVE TO W	BG 1548
SN DIMAS (1965)	699.506	L+T ON N EDGE OF CONC DR TO HSE NO 4040 LYMAN AVE 30FT E C/L + 275FT N OF BC	BG 1549
SN DIMAS (1965)	704.301	RDBM TAG IN N CB 1FT W BCR @ NW COR RUDDOCK ST + LYMAN AVE 73FT N + 60FT W C/L INT	BG 1551
SN DIMAS (1965)	752.540	CS MON IN WELL 12IN DN @ C/L INT BADILLO ST + CYPRESS AVE MKD (COVINA HIA)	BG 1554

QUAD-YEAR	ELEV	DESCRIPTION (INCLUDE QUAD AND YEAR IN DESCRIPTION)	BM NUMBER
SN DIMAS (1965)	754.885	CS MON IN WELL @ C/L INT CYPRESS AVE + VALLEY CENTER AVE	BG 1556
SN DIMAS (1965)	756.434	RDBM TAG IN CONC GUARD CORNER @ NW CYPRESS AVE + VALLEY CENTER AVE 19FT N + 16FT W, C/L INT	BG 1557
SN DIMAS (1965)	782.575	CS MON IN WELL 7IN DN @ C/L INT COVINA BLVD + VALLEY CENTER AVE	BG 1558
BASELINE (1965)	546.047	USC+GS BR DISC 4FT ABOVE WALK <b>OUT</b> EDGE OF BLDG @ SE COR BADILLO ST + CITRUS AVE FROM NW COR MKD (USC+GS BM NO 35)	BG 1689
SN DIMAS (1965)	764.295	L+BN IN CONC WINGWALL W SIDE FC CHANNEL 23FT S C/L CYPRESS AVE 1180FT E C/L VALLEY CENTER AVE	BG 1861
SN DIMAS (1965)	767.718	L+BN IN CONC HDWL FC CHANNEL <b>OUT</b> C/L CYPRESS AVE + 1265FT E C/L VALLEY CENTER AVE	BG 1862
SN DIMAS (1965)	780.457	L+BN IN S CB 18FT S C/L CYPRESS AVE 4FT W BCR OF DR TO HSE NO 1210 + 820FT W C/L LONE HILL AVE	BG 1863
SN DIMAS (1965)	796.477	L+BN N END CONC HDWL FC CHANNEL <b>OUT</b> 29FT N C/L CYPRESS AVE + 30FT W C/L LONE HILL AVE	BG 1864
SN DIMAS (1965)	795.738	CS MON IN WELL @ C/L INT CYPRESS AVE + LONE HILL AVE	BG 1865
SN DIMAS (1965)	807.972	L+T SW CORN CONC WK TO HSE NO <b>OUT</b> 1007 CYPRESS AVE 47FT N C/L + 540FT E LONE HILL AVE	BG 1867
SN DIMAS (1965)	825.793	L+BN N SIDE CONC UNDERGROUND STORAGE TANK 32FT S C/L CYPRESS AVE + 1290FT E LONE HILL AVE	BG 1868
SN DIMAS (1965)	851.026	CS MON IN WELL @ C/L INT CYPRESS AVE + AMELIA AVE	BG 1870
SN DIMAS (1965)	852.391	L+SPK IN CONC WK TO HSE NO 800 AMELIA AVE 17FT E C/L + 3FT N C/L PROD CYPRESS AVE	BG 1871
SN DIMAS (1965)	1015.658	STD BRONZE DISC IN CONC BRIDGE OVER SAN DIMAS WASH 0.2 MI E C/L SAN DIMAS AVE + 30FT N C/L FOOTHILL BLVD MKD (METROPOLITAN 51W)	BG 1934
SN DIMAS (1965)	1013.650	FC TAG IN E WINGWALL SAN DIMAS WASH 34FT S C/L FOOTHILL BLVD + 0.2MI E C/L SAN DIMAS AVE	BG 1935
SN DIMAS (1965)	1016.523	L+T IN CONC GUTTER OF ROCK RET WL NE COR SAN DIMAS AVE + FOOTHILL BLVD 60FT N + 50FT E C/L INT MKD (BM)	BG 1936
SN DIMAS (1965)	999.442	CS MON IN WELL 10IN DN NR <b>OUT</b> INT SAN DIMAS AVE + BASE LINE RD 10FT E + 10 FT S C/L INT MKD (BM 11-45)	BG 1938
SN DIMAS (1965)	1010.842	CS MON IN WELL 10IN DN NR C/L INT SAN DIMAS AVE + GLADSTONE AVE MKD (RE 329)	BG 1939
SN DIMAS (1965)	1011.266	SQ HD SPK W CB 6FT S BCR @ SW COR SAN DIMAS AVE + GLADSTONE AVE 25FT W + 31FT S C/L INT MKD (LV 17)	BG 1940
SN DIMAS (1965)	970.988	L+BN W CB 7FT N BCR @ NW COR SAN DIMAS AVE + 4TH ST 35FT N + 25FT W C/L INT MKD (LV 45)	BG 1941
SN DIMAS (1965)	970.179	CS MON IN WELL 10IN DN @ C/L INT SAN DIMAS AVE + 4TH ST MKD (C S MON)	BG 1942

QUAD-YEAR	ELEV	D E S C R I P T I O N (INCLUDE QUAD AND YEAR IN DESCRIPTION)	BM	NUMBER
SN DIMAS (1965)	953.074	SQ HD SPK E CB 12FT N BCR @ NE COR SAN DIMAS AVE + BONITA AVE 50FT N + 25FT E C/L INT MKD (SD 202)	BG	1943
SN DIMAS (1965)	923.144	CS MON IN WELL 8IN DN @ PT SAN DIMAS AVE 0.55MI S ARROW HWY MKD (RE 58 69)	BG	1946
SN DIMAS (1965)	944.589	CS MON IN WELL 6IN DN NR INT CANNON AVE + PUDDINGSTONE DR 0.65MI S ARROW HWY ON SAN DIMAS AVE MKD (RE 5869)	BG	1947
SN DIMAS (1965)	945.837	L+T N END CONC HDWL 20FT E C/L CANNON AVE 80FT E C/L SAN DIMAS AVE NR INT PUDDINGSTONE DR 0.65 MI S ARROW HWY ON SAN DIMAS AVE MKD (BM)	BG	1948
SN DIMAS (1965)	982.063	RDBM TAG CONC FTG OF E GATE TO BOAT LAUNCHING AREA 44FT S C/L + 1.2MI S ARROW HWY	BG	1949
SN DIMAS (1965)	981.461	RDBM TAG CONC FTG OF W GATE TO BOAT LAUNCHING AREA 35FT S C/L + 1.2MI S ARROW HWY	BG	1950
SN DIMAS (1965)	1057.217	L+T ON TOP OF ROCK WL NR INLET PIPE 20FT N C/L SAN DIMAS AVE + 2.3MI S ARROW HWY MKD (BM)	BG	1953
SN DIMAS (1965)	1057.708	L+T IN CONC FL ROCK INLET TO PIPE 3FT E OF ENT 20FT N APPROX C/L SAN DIMAS AVE + 2.3MI S ARROW HWY	BG	1954
SN DIMAS (1965)	1112.877	RD MON IN WELL 8IN DN NR ANG PT WIRE FENCE 100FT S BC + 50FT W C/L SAN DIMAS + 2.7MI S ARROW HWY (2IN IP 2FT W OF MON 3FT UP)	BG	1955
SN DIMAS (1965)	1115.100	RD MON IN WELL 8IN DN NR EXIT OF CUT 45FT FROM EC 30FT N C/L SAN DIMAS AVE + 2.7MI S ARROW HWY (2IN IP 2FT N OF MON 3FT UP)	BG	1956
SN DIMAS (1965)	892.717	RD MON IN WELL 4IN DN 36FT E C/L SAN DIMAS AVE 3FT S EC + 3.3MI S ARROW HWY (2IN IP 2FT E OF MON 3FT UP)	BG	1957
SN DIMAS (1965)	889.422	RDBM TAG IN CONC WATER TROUGH 45FT E C/L SAN DIMAS AVE 66FT S BC + 3.3MI S ARROW HWY	BG	1958
BASELINE (1965)	787.478	RDBM TAG N END OF ABUT OF BRIDGE NO 5 OVER SAN BERNARDINO FREEWAY 15FT W C/L SAN DIMAS AVE	BG	1959
BASELINE (1965)	786.503	RDBM TAG S END OF ABUT OF BRIDGE NO 5 OVER SAN BERNARDINO FREEWAY 15FT E C/L SAN DIMAS AVE	BG	1960
BASELINE (1965)	768.342	CS MON IN WELL 11IN DN @ C/L ROSECRANS ST 130FT SE C/L HOLT AVE MKD (BM 17-21 1952)	BG	1961
SN DIMAS (1965)	1016.581	CS MON IN WELL 10IN DN @ C/L INT GLADSTONE ST + CATARACT AVE MKD (RE 329)	BG	1963
SN DIMAS (1965)	1018.456	L+T IN CONC APRON OF DR N SIDE GLADSTONE ST 16FT N C/L + 65FT W C/L CATARACT AVE MKD (BM)	BG	1964
SN DIMAS (1965)	1018.315	CS MON IN WELL 8IN DN C/L INT GLADSTONE ST + PROP ACACIA ST MKD (CO SUR RE 63)	BG	1965
SN DIMAS (1965)	1011.739	CS MON IN WELL 8IN DN C/L INT GLADSTONE ST + PROP EUCLA AVE MKD (CO SUR RE 63)	BG	1966
SN DIMAS (1965)	912.314	CS MON IN WELL 10IN DN 10FT S + 10FT W C/L INT GLADSTONE ST + AMELIA AVE MKD (BM 11 42 1952 RE 63)	BG	1967

QUAD-YEAR	ELEV	DESCRIPTION (INCLUDE QUAD AND YEAR IN DESCRIPTION)	BM NUMBER
SN DIMAS (1965)	912.969	L+T N CB S SERV ISL 2FT W BCR @ SW COR GLADSTONE ST + PEARLANNA DR 35FT S + 30FT W C/L INT (AMELIA AVE)	BG 1968
SN DIMAS (1965)	901.531	L+N S CB GLADSTONE ST ON C/L PROD GRAVETON AVE 28FT S C/L INT	BG 1969
SN DIMAS (1965)	900.968	L+T N CB SERV RD IN BCR @ NW COR GLADSTONE ST + GRAVETON AVE 46FT W + 70FT N C/L INT	BG 1970
SN DIMAS (1965)	884.855	RDBM TAG S CB 28FT S C/L GLADSTONE ST 151FT W C/L SANTA FE RR TRACK NR E END OF CATCH BASIN	BG 1971
SN DIMAS (1965)	872.416	CS MON IN WELL 8IN DN NR C/L INT LONE HILL AVE + GLADSTONE ST MKD (CO SUR RE 63)	BG 1972
SN DIMAS (1965)	853.046	RDBM TAG S CB 28FT S C/L GLADSTONE ST 0.2MI W LONE HILL AVE 15FT E OF END OF BLOCK FENCE	BG 1973
SN DIMAS (1965)	829.155	CS MON IN WELL 10IN DN @ ANGLE PT NR C/L INT VALLEY CENTER AVE + GLADSTONE ST MKD (RESET 1957 TRIANG GLENDORA H-11)	BG 1974
SN DIMAS (1965)	810.220	RDBM TAG N CB GLADSTONE ST 3FT E BCR @ NE COR BRADFORD DR 28FT N + 60FT E C/L INT	BG 1975
SN DIMAS (1965)	796.358	CS MON IN WELL 10IN DN 10FT S + 200FT E C/L INT GLADSTONE ST + SUNF OLE AVE MKD (BM 11 38 1952 RE 63)	BG 1976
SN DIMAS (1965)	776.235	CSMON IN WELL 8IN DN @ PI OF 1ST CURVE GLADSTONE ST NW OF SAN DIMAS CHANNEL 0.2MI NW OF BRIDGE + 300FT E C/L LYMAN AVE MKD (CO SUR RE 63)	BG 1977
SN DIMAS (1965)	732.052	L+B E CB LFT S BCR @ SE COR GLADSTONE ST + CONCORD LANE 60FT S + 18FT E C/L INT	BG 1980
SN DIMAS (1965)	730.544	L+T S CB 2FT W BCR @ SW COR GLADSTONE ST + CONCORD LANE 24FT S + 55FT W C/L INT MKD (LS 2723)	BG 1981
SN DIMAS (1965)	619.446	CS MON IN WELL @ C/L INT BEN LOMOND AVE + GLADSTONE ST MKD (GLENDORA C-11 1956)	BG 1984
SN DIMAS (1965)	612.138	FC BR CAP FLUSH 42FT N C/L GLADSTONE ST + 60FT W C/L BIG DALTON CHANNEL BRIDGE NO B1242 MKD (81-RW-215)	BG 1985
SN DIMAS (1965)	906.345	L+T CONC DR TO HSE @ NW COR COVINA BLVD + CATARACT AVE 70FT N + 27FT W C/L INT MKD (BM)	BG 1986
SN DIMAS (1965)	865.333	BT SPK E CONC WALL 10FT @ NW COR OF DR TO HSE @ NW COR COVINA BLVD + PROUDMAN ST 40FT N C/L + 1000FT W CATARACT AVE	BG 1987
SN DIMAS (1965)	866.193	L+T W CONC WALL 10FT W @ NW COR OF DR TO HSE @ NW COR COVINA BLVD + PROUDMAN ST 60FT N C/L + 1000FT W CATARACT AVE MKD (BM)	BG 1988
SN DIMAS (1965)	846.694	CS MON IN WELL 13IN DN NR C/L INT COVINA BLVD + AMELIA AVE MKD (RE 329)	BG 1989
SN DIMAS (1965)	688.406	L+BRAD E CB 9FT N BCR @ NE COR COVINA BLVD + MANGROVE AVE 55FT N + 18FT E C/L INT	BG 2000
SN DIMAS (1965)	687.601	L+BRAD N CB SERV ISL 8FT W BCR @ NW COR MANGROVE AVE + COVINA BLVD 77FT W + 30FT N C/L INT	BG 2001

QUAD-YEAR	ELEV	DESCRIPTION (INCLUDE QUAD AND YEAR IN DESCRIPTION)	BM NUMBER
SN DIMAS (1965)	671.317	CS MON IN WELL 8IN DN @ C/L INT COVINA BLVD + GLENDDORA AVE MKD (E-1RE 63)	BG 2002
SN DIMAS (1965)	655.412	RDBM TAG E END OF CUL-DE-SAC OF SERV RD N SIDE COVINA BLVD 49FT N C/L + 1200 FT W GLENDDORA AVE	BG 2003
SN DIMAS (1965)	654.566	RDBM TAG S CB COVINA BLVD 30FT S C/L + 1250FT W GLENDDORA AVE NEAR CUL-DE-SAC ON N SIDE OF BLVD	BG 2004
SN DIMAS (1965)	617.569	L+BRAD N CB COVINA BLVD 40FT N C/L ON C/L PROD STARCREST DR	BG 2005
SN DIMAS (1965)	616.769	L+BRAD W CB 6FT S BCR @ SW COR COVINA BLVD + STARCREST DR 73FT S + 18FT W C/L INT	BG 2006
SN DIMAS (1965)	601.819	L+T 1FT E BCR @ NE COR COVINA BLVD + BARRANCA AVE 67 FT E + 30FT N C/L INT	BG 2007
SN DIMAS (1965)	601.792	CS MON FLUSH 6FT BACK OF RET @ NE COR COVINA BLVD + BARRANCA AVE 55FT N + 33FT E C/L INT MKD (RM NO 1)	BG 2008
SN DIMAS (1965)	585.760	L+T E CB 7FT N BCR @ COR COVINA BLVD + FAIRVALLEY AVE 71FT N + 18FT E C/L INT	BG 2009
SN DIMAS (1965)	584.405	L+N N CB COVINA BLVD (S CB OF ISLAND) 6FT W BCR 32FT N C/L 40FT W C/L FAIRVALLEY AVE	BG 2010
SN DIMAS (1965)	607.694	L+T W EDGE OF CONC WK TO CHURCH BLDG NO 1067 BADILLO ST 118FT N C/L + 95FT E GRAND AVE	BG 2013
SN DIMAS (1965)	609.397	CS MON IN WELL C/L BADILLO ST 1000FT E GRAND AVE MKD (RE 63)	BG 2014
SN DIMAS (1965)	642.556	RDBM TAG W CB ASHTON DR 1FT S BCR @ SW COR BADILLO ST 18FT W + 55FT S C/L INT	BG 2015
SN DIMAS (1965)	642.987	RDBM TAG E CB ASHTON DR 1FT S BCR @ SE COR BADILLO ST 18FT E + 55FT S C/L INT	BG 2016
SN DIMAS (1965)	663.148	RDBM TAG IN CB BADILLO ST 1FT E BCR @ NW COR DARFIELD AVE 20FT N + 44FT W C/L INT	BG 2017
SN DIMAS (1965)	664.635	RDBM TAG N CB BADILLO ST 2FT E BCR @ NE COR DARFIELD AVE 20FT N + 48FT E C/L INT	BG 2018
SN DIMAS (1965)	718.259	CS MON IN WELL @ C/L INT LYMAN AVE + CYPRESS ST	BG 2019
SN DIMAS (1965)	717.754	L+T S CB CYPRESS ST @ BCR SW COR LYMAN AVE 55FT W + 28FT S C/L INT	BG 2020
BASELINE (1965)	584.582	FC MON IN SW WINGWALL OF BRIDGE B1237 ON CITRUS AVE OVER BIG DALTON WASH 37FT W C/L MKD (BM 81-39)	BG 2021
BASELINE (1965)	585.060	L+BRAD E CB CITRUS AVE @ NE END OF BRIDGE B1237 OVER BIG DALTON WASH 30FT E C/L	BG 2022
BASELINE (1965)	572.286	L+SPK W CB 40FT W C/L CITRUS AVE + 57FT N OF N END BRIDGE B1228 OVER SAN DIMAS WASH	BG 2024
SN DIMAS (1965)	739.773	CS MON IN WELL 8IN DN NR C/L INT BONNIE COVE AVE + JUANITA AVE MKD (RE 63)	BG 2025
SN DIMAS (1965)	740.962	L+T W CB 1FT S BCR @ SW COR BONNIE COVE AVE + JUANITA AVE 35FT S + 20FT W C/L INT	BG 2026

QUAD-YEAR	ELEV	DESCRIPTION (INCLUDE QUAD AND YEAR IN DESCRIPTION)	BM NUMBER
SN DIMAS (1965)	721.675	L+T N CB 1FT E BCR @ NE COR BONNIE COVE AVE + CIENEGA AVE 30FT N + 58FT E C/L INT	BG 2027
SN DIMAS (1965)	694.751	T+T IN WELL 16IN DN C/L INT BONNIE COVE AVE + CYPRESS ST	BG 2030
SN DIMAS (1965)	822.786	L+T S CB 2FT E BCR @ SE COR VALLEY CENTER AVE + JUANITA AVE 36FT E + 20FT S C/L INT MKD (CSBM)	BG 2031
SN DIMAS (1965)	821.264	L+T S CB 3FT W BCR @ SW COR VALLEY CENTER AVE + JUANITA AVE 37FT W + 20FT S C/L INT	BG 2032
SN DIMAS (1965)	792.131	CS MON IN WELL 8IN DN C/L INT VALLEY CENTER AVE + CIENEGA AVE MKD (RE 63)	BG 2033
SN DIMAS (1965)	791.516	RDBM TAG E CB VALLEY CENTER AVE 32FT E C/L + 190FT S C/L CIENEGA AVE NR ENT CATCH BASIN	BG 2034
SN DIMAS (1965)	895.597	RDBM TAG W CB 1FT N BCR @ NW COR EUCLA AVE + ARROW HWY 77FT N + 20FT W C/L INT	BG 2035
SN DIMAS (1965)	896.350	RDBM TAG E CB 1FT N BCR @ NE COR EUCLA AVE + ARROW HWY 80FT N + 20FT E C/L INT	BG 2036
SN DIMAS (1965)	885.455	L+T CONC WK TO HSE @ SE COR AMELIA AVE + CIENEGA AVE 40FT S + 82FT E C/L INT (BM)	BG 2037
SN DIMAS (1965)	884.372	CS MON IN WELL 15IN DN NR C/L INT AMELIA AVE + CIENEGA AVE (USE N EDGE)	BG 2038
SN DIMAS (1965)	945.851	RDBM TAG CONC HDWL @ SE COR 5TH ST + AMELIA AVE 105FT E + 12FT S C/L INT	BG 2039
SN DIMAS (1965)	944.627	CS MON IN WELL 12IN DN NR C/L INT 5TH ST + AMELIA AVE (USE S EDGE) MKD (RE 329)	BG 2040
SN DIMAS (1965)	925.114	CS MON IN WELL 8IN DN NR C/L INT AMELIA AVE + ALLEN AVE MKD (RE 63)	BG 2041
SN DIMAS (1965)	954.464	RDBM TAG E CB 1FT N BCR @ SE COR AMELIA AVE + FOOTHILL BLVD 88FT S + 20FT E C/L INT	BG 2043
BASELINE (1965)	798.270	CS MON IN WELL 13IN DN IN CTR PKWY RET @ C/L 2ND ST 96FT E C/L BELLEVUE AVE	BG 2076
SN DIMAS (1965)	1160.200	CS MON IN WELL 10IN DN @ SW COR WHEELER + LA VERNE RD + BASE LINE RD 10FT S + 10FT W C/L INT MKD (BM 11-52)	BG 2129
SN DIMAS (1965)	1231.347	CS MON FLUSH 1FT W OF CB @ NW COR WHEELER + LA VERNE RD + ALDERGATE RD 47FT N + 31FT W C/L INT MKD (BM 53-1)	BG 2130
SN DIMAS (1965)	1247.486	CS TAG CONC POST IN WELL 8IN DN C/L WHEELER + LA VERNE RD 0.2MI N ALDERSGATE RD MKD (CO ENG)	BG 2131
SN DIMAS (1965)	1296.988	CS MON IN WELL 2IN DN ON W FENCE LINE OF CO FIRE STA NO 104 36FT N C/L WHEELER + LA VERNE RD + 0.6MI N LADERSGATE RD MKD (LOT COR)	BG 2133
SN DIMAS (1965)	1323.781	CS MON 3/4IN IP IN CONC WITH TAG IN WELL 10IN DN @ C/L WHEELER + LA VERNE RD 0.9MI N ALDERSGATE RD @ C/L OF TOWER LINE	BG 2134
SN DIMAS (1965)	1407.780	CS MON IN WELL 8IN DN NR C/L INT WHEELER + LA VERNE RD + SAN DIMAS CANYON RD MKD (CO SUR)	BG 2135
SN DIMAS (1965)	1257.989	RD SPK IN 3/4IN IP IN WELL 15IN DN @ C/L SAN DIMAS CANYON RD E + 36FT E C/L SAN DIMAS CANYON RD N	BG 2137

QUAD-YEAR	ELEV	DESCRIPTION (INCLUDE QUAD AND YEAR IN DESCRIPTION)	BM NUMBER
SN DIMAS (1965)	1255.603	USGS MON IN RET WALL @ NW COR SAN DIMAS CANYON RD N + SAN DIMAS CANYON RD E 60FT N + 24FT W C/L INT MKD (GAGING STA)	BG 2138
SN DIMAS (1965)	1171.828	L+N IN S CONC FOOTING OF STEEL TOWER NO 233 D2 50FT W SAN DIMAS CANYON RD + 1.3MI N FOOTHILL BLVD	BG 2139
SN DIMAS (1965)	1132.022	FC MON 2IN DN NR S END OF SPUR RD 5FT N OF 2IN REF PIPE 25FT E C/L SAN DIMAS CANYON RD 1MI N FOOTHILL BLVD MKD (88RW 197)	BG 2140
SN DIMAS (1965)	1106.788	FC MON 2IN DN 60FT E C/L SAN DIMAS CANYON RD + 550FT N C/L RAMOLA AVE 5FT S OF 2IN REF PIPE MKD (88RW 183)	BG 2141
SN DIMAS (1965)	1090.747	CS MON 2IN DN @ SW COR SAN DIMAS CANYON RD + RAMOLA AVE 100FT S + 50FT W C/L INT MKD (NO16)	BG 2143
SN DIMAS (1965)	1113.639	USC+GS MON 1IN UP @ NE COR BASE LINE RD 100FT NE FOOTHILL BLVD + 1FT WLY STONE WALL MKD (USC+GS GARRETT 1929)	BG 2144
SN DIMAS (1965)	1168.650	FC MON @ SE END OF BRIDGE OVER WASH 13FT S C/L BASE LINE RD 180FT E MAIN ENTREE LINE HEIGHTS SCHOOL 1000FT E WHEELER + LA VERNE RD MKD (94-36)	BG 2145
SN DIMAS (1965)	1162.449	CS MON IN WELL 5FT W C/L EMERALD AVE + 5FT S C/L BASELINE RD MKD (BM 11-54 1952 RE 63)	BG 2146
SN DIMAS (1965)	1159.231	CS MON IN CONC POST 6 IN UP 3FT S C/L BASE LINE RD + 555FT E EMERALD AVE	BG 2148
BASELINE (1965)	1171.085	CS MON IN WELL 8FT W C/L FRUIT ST + 100FT S C/L BASE LINE RD MKD (BM 13-11 1952 RE 63)	BG 2149
BASELINE (1965)	1037.430	CS MON IN WELL 1FT E OF 100 FT CB WHITE AVE 104FT N C/L ARROW HWY (LA VERNE RD) + 27FT E C/L WHITE AVE MKD (BM 13-7 RE 63 1952)	BG 2176
BASELINE (1965)	1037.157	RDBM TAG IN W CB WHITE AVE 100 FT S BCR @ SW COR ARROW HWY 34FT W + 68FT S C/L INT	BG 2177
SN DIMAS (1965)	1044.102	L+T CONC SLAB FRONT OF AT+SF LA VERNE DEPOT @ NW COR 105FT W C/L E ST + 108FT S C/L ARROW HWY	BG 2178
SN DIMAS (1965)	1030.696	CONC NAIL S CB ARROW HWY (PALOMARES AVE) 15FT E DR TO HSE NO 1742 17FT S C/L	BG 2179
SN DIMAS (1965)	1035.562	L+BN IN SW COR CONC RR SIGNAL BASE ON S SIDE AT+SF RR 120FT E C/L PARK AVE PROD	BG 2180
SN DIMAS (1965)	1064.128	L+BN N CB BONITA AVE (4 HSB) 19FT E BCR @ SE COR G ST 25FT S + 44FT E C/L INT	BG 2181
BASELINE (1965)	1082.392	CS MON IN WELL 2FT N OF N CB 7TH ST 17FT W BCR @ SW COR WHITE AVE 18FT N + 43FT W C/L INT	BG 2182
BASELINE (1965)	1064.595	L+BN W CB WHITE AVE 10FT S BCR @ SW COR BONITA AVE 25FT W + 71FT S C/L INT	BG 2183
BASELINE (1965)	1152.388	COE MON 3IN UP @ SW COR FOOTHILL BLVD + LINCOLN AVE (WHITE AVE) 41FT S + 21FT W C/L INT	BG 2184
SN DIMAS (1965)	1048.218	L+BN S CB 3RD ST 5FT E BCR @ SE COR AVE D 28FT S + 55FT E C/L INT	BG 2196



QUAD-YEAR	ELEV	DESCRIPTION (INCLUDE QUAD AND YEAR IN DESCRIPTION)	BM NUMBER
SN DIMAS (1965)	1046.369	USC+GS MON 16IN UP N WALL OF BUILDERS HALL @ NE COR OF BLDG @ LA VERNE COLLEGE BRD AVE + C ST MKD (USC+GS B-96)	BG 2197
SN DIMAS (1965)	1043.602	L+BN N CB BONITA AVE 2FT W BCR @ NW COR PARK AVE 26FT N + 57FT W C/L INT	BG 2198
BASELINE (1965)	995.976	CS MON IN WELL IN L A CO FAIR GROUNDS @ CHAIN LINK FENCE ON E PROP LINE OF FAIR GROUNDS 18FT NW C/L PROD FAIR AVE 118' C/L WHITE AVE NR PP NO 1199570E MKD (LACFG NO 53)	BG 2199
BASELINE (1965)	563.803	CS MON 8IN DN ON SE COR CYPRESS AVE + CITRUS AVE 1FT BACK CB 40FT S + 31FT E C/L INT MKD (BM 17 3A)	BG 2430
BASELINE (1965)	580.218	RDBM TAG IN CB 1FT N BCR @ NE COR GRAND AVE + ROWLAND AVE 30FT N + 40FT E C/L INT	BG 2434
BASELINE (1965)	580.545	CS TAG IN CB 1FT S BCR @ NW COR GRAND AVE + ROWLAND AVE 45FT W + 55FT N C/L INT	BG 2435
SN DIMAS (1965)	732.562	CS MON 6IN DN @ OR NR GRAND AVE + BENNETT AVE MKD (CO SUR 3)	BG 2538
SN DIMAS (1965)	731.713	L+T N CB 5FT W BCR 25FT N + 35FT W C/L INT GRAND AVE + BENNETT AVE	BG 2539
SN DIMAS (1965)	756.824	CS MON IN WELL 12IN DN N ONE OF TWO @ OR NR C/L INT GRAND AVE + LEADORA AVE MKD (CO ENG RE 5869)	BG 2540
SN DIMAS (1965)	760.166	L+T E CB 3FT N BCR 70FT N + 40FT E C/L INT GRAND AVE + LEADORA AVE	BG 2541
SN DIMAS (1965)	812.137	CS MON IN WELL 7IN DN @ C/L INT GRAND AVE + SIERRA MADRE AVE MKD (CO SUR RE 63)	BG 2542
SN DIMAS (1965)	814.198	L+T IN CONC HDWL @ NE COR GRAND AVE + SIERRA MADRE AVE 2 FT + 15FT E C/L INT GRAND AVE + SIERRA MADRE AVE	BG 2543
SN DIMAS (1965)	833.886	L+T N CB 40FT E BCR @ NE COR SIERRA MADRE AVE + PENNSYLVANIA AVE 27FT N + 55FT E C/L INT	BG 2544
SN DIMAS (1965)	832.500	L+T S CB 5FT E BCR @ SE COR SIERRA MADRE AVE + PENNSYLVANIA AVE 57FT E + 20FT S C/L INT	BG 2545
SN DIMAS (1965)	857.666	RDBM TAG W CB 1FT S FUTURE BCR @ SW COR VISTA BONITA AVE + SIERRA MADRE AVE 42FT S + 15FT W C/L INT	BG 2546
SN DIMAS (1965)	860.114	RAM SET E CB 1FT S FUTURE BCR @ SE COR VISTA BONITA AVE + SIERRA MADRE AVE 42FT S + 15FT E C/L INT	BG 2547
SN DIMAS (1965)	930.363	L+T IN CONC FTG OF 5FT LINK FENCE @ NW COR BANNA AVE + SIERRA MADRE AVE 40FT N + 24FT W C/L INT	BG 2548
SN DIMAS (1965)	930.198	L+T CONC SIDE RAIL OF 2ND STEP TO ENT OF HSE @ NE COR BANNA AVE + SIERRA MADRE AVE 16FT N + 13FT E C/L INT	BG 2549
SN DIMAS (1965)	935.719	CO ENG TAG W CB 25FT S OF BCR @ SW COR SIERRA MADRE AVE + LIVE OAK AVE 58FT S + 17FT W C/L INT	BG 2550
SN DIMAS (1965)	940.084	RD HD SPK + L IN N CB 1 FT E BCR @ NE COR SIERRA MADRE AVE + LIVE OAK AVE	BG 2551
SN DIMAS (1965)	1022.924	CS MON IN WELL 10IN DN @ OR NR C/L INT LIVE OAK AVE + PALM DR MKD (R-9-W T-1-N 19-20-30-29)	BG 2553

QUAD-YEAR	ELEV	DESCRIPTION (INCLUDE QUAD AND YEAR IN DESCRIPTION)	BM NUMBER
SN DIMAS (1965)	1009.366	FC BR CAP MON IN N HDWL OF CHANNEL 30FT N C/L PALM DR + 1200FT E LIVE OAK AVE MKD (BM 85-67)	BG 2555
SN DIMAS (1965)	989.178	CS MON IN WELL 10IN DN @ C/L INT PALM DR + LORAIN AVE MKD (1/4 COR SEC 20-29)	BG 2556
SN DIMAS (1965)	988.754	L+T N EDGE CONC WLK TO HSE NO 7760 LORAIN AVE 37FT S + 26FT E C/L INT PALM DR + LORAIN AVE	BG 2557
SN DIMAS (1965)	953.256	RD HD SPK W CB 12FT S BCR 84FT S + 30FT W C/L INT LORAIN AVE + SIERRA MADRE AVE	BG 2558
SN DIMAS (1965)	955.845	L+T IN CONC DR TO HSE NO 1110 SIERRA MADRE AVE 1FT E OF W EDGE 114FT E + 61FT S C/L INT LORAIN AVE + SIERRA MADRE AVE	BG 2559
SN DIMAS (1965)	1002.813	L+T E SIDE SQ WEIR BOX 15FT S + 20FT W C/L INT GLEN DORA MT RD + SIERRA MADRE AVE	BG 2562
SN DIMAS (1965)	937.060	RDBM TAG E CB NR FIRE HYDT FRONT OF HSE NO 354 VALLEY CENTER AVE 1700FT S SIERRA MADRE AVE + 25FT E C/L	BG 2564
SN DIMAS (1965)	937.785	RDBM TAG E WALL OF CHANNEL IN FRONT OF HSE NO 354 VALLEY CENTER AVE 53FT W C/L + 1700FT S SIERRA MADRE AVE	BG 2565
SN DIMAS (1965)	901.922	RDBM TAG E CB @ S END CB IN FRONT OF HSE NO 170 N VALLEY CENTER AVE 18FT E C/L + 700FT N FOOTHILL BLVD	BG 2566
SN DIMAS (1965)	882.753	L+T N CB 1FT W BCR @ NE COR VALLEY CENTER AVE + FOOTHILL BLVD 30FT N + 58FT E C/L INT (NR CB)	BG 2567
SN DIMAS (1965)	882.042	CS MON IN WELL 12IN DN @ C/L INT FOOTHILL BLVD + VALLEY CENTER AVE MKD (CO SUR MON RE 63)	BG 2568
BASELINE (1965)	625.380	RD TAG IN E CB 30FT S BCR @ SE COR CITRUS AVE + FOOTHILL BLVD 80FT S + 40FT E C/L INT	BG 2652
BASELINE (1965)	625.439	CS MON NR C/L INT CITRUS AVE + FOOTHILL BLVD TO THE W	BG 2653
BASELINE (1965)	589.038	CSBM MON IN WINGWALL OF BRIDGE NO 1408 NE COR GRAND AVE + BADILLO ST 80FT N + 50FT E MKD (BM 17-8B 1963)	BG 2654
BASELINE (1965)	586.651	R D MON @ C/L INT GLADSTONE AVE + CITRUS AVE	BG 2655
BASELINE (1965)	570.698	COE BR CAP W CB 90FT N BCR + 140FT N + 40FT W C/L INT TUDOR ST + CITRUS AVE MKD (SD 6-1956)	BG 2658
BASELINE (1965)	565.441	CS TRI MON IN WELL 12IN DN @ OR NR C/L INT CITRUS AVE + COVINA BLVD MKD (COVINA BL 1957)	BG 2659
BASELINE (1965)	566.085	RD HD SPK IN W CB 67FT S BCR @ SW COR CITRUS AVE + COVINA BLVD 110FT S + 35FT W C/L INT MKD (BM NO 139)	BG 2660
BASELINE (1965)	560.759	USC+GS BR CAP S END CATCH BASIN 40FT E C/L CITRUS AVE 35FT S OF BENBOW ST MKD (K1149 1961)	BG 2661
BASELINE (1965)	553.637	RDBM TAG E CB 1FT N BCR @ NE COR SAN BERNARDINO RD + CITRUS AVE 27FT E + 44FT N C/L INT	BG 2663
BASELINE (1965)	552.851	RDBM TAG W CB 1FT S BCR @ SW COR SAN BERNARDINO RD + CITRUS AVE 27FT W + 37FT S C/L INT	BG 2664

QUAD-YEAR	ELEV	DESCRIPTION (INCLUDE QUAD AND YEAR IN DESCRIPTION)	BM NUMBER
BASELINE (1965)	541.653	CS TRI MON IN WELL 10IN DN @ OR NR C/L INT BADILLO ST + CITRUS AVE MKD (COVINA B2 1957)	BG 2665
BASELINE (1965)	560.462	RDBM TAG N CB 16FT E BCR @ <del>NE</del> <b>OUT</b> BADILLO ST + BARRANCA AVE 40FT N + 70FT <b>OUT</b> INT	BG 2666
BASELINE (1965)	587.546	RDBM TAG S CB 5FT W BCR @ SW COR GRAND AVE + BADILLO ST 40FT S + 74FT W C/L INT E END CATCH BASIN	BG 2667
BASELINE (1965)	521.982	COE BR MON IN CB OF ISLAND @ OAK CN RD 36FT S C/L COVINA HILLS RD MKD (W C 28 1957)	BG 2668
BASELINE (1965)	528.794	CS MON IN WELL 10IN DN 9FT SW + 12FT SE C/L INT COVINA HILLS RD + CHAPPARRO RD MKD (BM 17-11 1952)	BG 2669
BASELINE (1965)	635.682	CS MON 12IN WELL W/COVER 0.55MI E CHAPARRO RD + 8FT S C/L COVINA HILLS RD MKD (BM 17-12 1952 RE 63)	BG 2670
BASELINE (1965)	652.202	CS MON 12IN DN IN WELL W/COVER 20FT W + 10FT N C/L INT COVINA HILLS RD + HOLT AVE MKD (BM 17-13 1952 RE 63)	BG 2671
BASELINE (1965)	733.455	CS MON 12IN DN IN WELL W/COVER 0.4MI E C/L HOLT AVE + 8FT SE C/L COVINA HILLS RD MKD (BM 17-14 1952 RE 63)	BG 2672
BASELINE (1965)	865.999	CS MON 12IN DN IN WELL W/COVER 0.8MI E ALONG COVINA HILLS RD FROM INT HOLT AVE + 26FT E CTR PRIVATE DRIVE TO HSE NO 21144 MKD (BM 17-15 1952 RE 63)	BG 2673
BASELINE (1965)	865.667	CS MON IN WELL 10IN DN ON C/L PVMT COVINA HILLS RD NR C/O DR TO HSES NO 21542 + NO 21554 MKD (BM 17-16 1952)	BG 2674
BASELINE (1965)	774.886	COE BR MON FLUSH IN WINGWALL OF DRAIN TO SAN JOSE CR CHANNEL 36FT E C/L HOLT AVE + 100FT S BRIDGE NO 53-107 MKD (TS J 110 1960)	BG 2675
BASELINE (1965)	845.954	L+BN E CB WHITE AVE 1FT N BCR @ NE COR 2ND ST 61FT N + 42FT E C/L INT	BG 2787
BASELINE (1965)	858.342	CS MON IN WELL 7IN DN IN GUTTER @ SW COR HOLT AVE + WHITE AVE 36FT S + 55FT W C/L INT MKD (BM 13-1 1952)	BG 2788
BASELINE (1965)	884.661	CS MON 8IN DN @ SE COR WHITE AVE + ORANGE GROVE AVE 46FT E C/L WHITE AVE + 2FT S OF S CB LINE ORANGE GROVE AVE	BG 2789
BASELINE (1965)	929.387	CS MON 10IN DN IN PARKING <del>AREA</del> <b>OUT</b> PARK 241FT WLY WHITE AVE + 108FT SLY MCKINLEY AVE MKD (13-3)	BG 2790
BASELINE (1965)	950.071	CS MON IN LA CO FAIR GRDS 78FT ELY + 66FT SLY OF SELY COR MAIN EXHIBIT BLDG 25FT NLY OF ENTRANCE GATE	BG 2791
BASELINE (1965)	966.827	CS MON 10IN DN IN LA CO FAIR GRDS 88FT NLY FROM NELY COR MAIN EXHIBIT BLDG + 39FT WLY FROM FIRE HYDRANT	BG 2792
BASELINE (1965)	987.438	CS MON 7IN DN 40FT SWLY FROM NELY COR BARN NO 11 + 30FT SLY FROM 14IN COTTONWOOD TREE	BG 2793
BASELINE (1965)	1001.120	L+PK E CB WHITE AVE 12FT S OF S EDGE CONC APRON OF GATE 14 TO LA CO FAIR GRDS 0.4MI S ARROW HWY 40FT E C/L WHITE AVE	BG 2794

QUAD-YEAR	ELEV	DESCRIPTION (INCLUDE QUAD AND YEAR IN DESCRIPTION)	BM NUMBER
BASELINE (1965)	1065.247	L+BN S CB BONITA AVE 0.5FT W BCR @ SE COR WHITE AVE 37FT E @ 25FT S C/L INT	BG 2797
BASELINE (1965)	1102.774	L+BN E CB WHITE AVE 1FT S BCR @ SE COR KENDALL ST 50FT S + 40FT E C/L INT	BG 2798
BASELINE (1965)	1104.469	L+BN E CB WHITE AVE 1FT N BCR @ NE COR KENDALL ST 45FT N + 40FT E C/L INT	BG 2799
BASELINE (1965)	1135.783	BT SPK N CB FOOTHILL BLVD 0.8FT W BCR @ NW COR FRUIT ST 107FT W + 37FT N C/L INT	BG 2800
BASELINE (1965)	1139.340	BT SPK W CB FOOTHILL BLVD 61FT N BCR @ NW COR FRUIT ST 163FT N + 40FT W C/L INT	BG 2801
BASELINE (1965)	1155.425	CS MON C/L FRUIT ST 1300FT N C/L FOOTHILL BLVD @ HSE NO 3835 MKD (RE 5869)	BG 2802
BASELINE (1965)	1160.804	CS MON 10IN DN @ C/L INT FRUIT ST + BOWDOIN ST MKD (RE 5869)	BG 2803
BASELINE (1965)	1173.780	CS MON 10IN DN @ C/L INT BASELINE RD + FRUIT ST	BG 2804
SN DIMAS (1965)	680.369	RD MON IN WELL 8IN DN @ PI OF CURVE 800FT W OF GLENDORA AVE NR BLDG 19801 ARROW HWY MKD (RD DEPT 1960)	BG 2882
SN DIMAS (1965)	732.005	RDBM TAG S CB 1FT E BCR @ SE COR ARROW HWY + BONNIE COVE AVE 42FT S + 56FT E C/L INT	BG 2883
SN DIMAS (1965)	809.206	CS MON IN WELL 8IN DN @ C/L INT ARROW HWY + VALLEY CENTER AVE MKD (RE 5869)	BG 2884
SN DIMAS (1965)	920.825	L+BN E CB CATARACT <b>OUT</b> 20FT E C/L + 100FT N C/L ARROW HWY	BG 2885
SN DIMAS (1965)	984.091	L+BN IN 10IN STAND PIPE 63FT S C/L ARROW HWY STA 502+85 1000FT E WALNUT AVE MKD (27)	BG 2886
SN DIMAS (1965)	985.826	CHIS X TOP BOLT OF SIGNAL CONTROL BOX S SIDE SANTA FE RR 320FT W C/L INT OLD CIENEGA AVE + RR	BG 2887
SN DIMAS (1965)	998.785	RD MON IN WELL 8IN DN @ C/L INT ARROW HWY + SAN DIMAS CYN RD MKD (LA CO RD DEPT 1952)	BG 2888
SN DIMAS (1965)	1007.255	L+BN CTR S SIDE CONC BASE <b>OUT</b> OF SIGNAL TOWER NO 1092 S SIDE SFRR 600FT E @ SAN DIMAS CYN RD	BG 2889
SN DIMAS (1965)	1009.380	FC BR DISC S HDWL RR BR OVER CHANNEL TO PUDDING-STONE LAKE 93FT S C/L ARROW HWY 1000FT E SAN DIMAS CYN RD MKD (BM 95-2)	BG 2890
SN DIMAS (1965)	1014.860	L+BN W END CONC HDWL OF CONC CULV 12FT S OF S RAIL SFRR + 350FT W CARRION RD	BG 2891
SN DIMAS (1965)	1016.506	RD MON IN WELL 8IN DN @ C/L INT ARROW HWY + CARRION RD MKD (1958)	BG 2892
SN DIMAS (1965)	1024.535	COE BR DISC CTR CONC CULV 20FT S C/L ARROW HWY 460FT W C/L PROD FIREY AVE MKD (MC-104-1961)	BG 2893
SN DIMAS (1965)	1027.096	COE BR DISC IN CONC MON 240FT E C/L PROD FIREY AVE 22FT S C/L ARROW HWY <b>OUT</b> N PP 121626E SET FLUSH MKD(MC-103-1961)	BG 2894
SN DIMAS (1965)	1045.959	CHIS X ON BOLT CTR RR <b>OUT</b> CONTROL BOX @ NE COR ARROW HWY + E ST <b>OUT</b> N + 54FT E APPROX C/L INT	BG 2895

QUAD-YEAR	ELEV	DESCRIPTION (INCLUDE QUAD AND YEAR IN DESCRIPTION)	BM	NUMBER
SN DIMAS (1965)	948.178	BEG @ INT ARROW HWY + SAN DIMAS AVE THENCE SLY ALG SAN DIMAS AVE 2.9MI FD CS BR MON 2IN UP 40FT WLY APPROX C/L PAVED RD CLOSE TO PI OF LARGE CURVE MKD (BM P-15 RE 5869)	BG	2896
SN DIMAS (1965)	1003.154	BEG @ INT ARROW HWY + SAN DIMAS AVE THENCE SLY ALG SAN DIMAS AVE 1.6MI TO PI OF 1ST CURVE S OF DAM FD 1/2IN IP 6IN DN 18FT ELY APPROX C/L NRENT TO GATE 5-1/2	BG	2897
SN DIMAS (1965)	976.696	L+BRAD E END RK HDWL DRAIN PIPE 0.45MI ELY SAN DIMAS AVE 25FT N C/L PUDDINGSTONE DR 130FT NELY TP NO 2359-LAC FCD 40FT WLY PI N-12 MKD (BM)	BG	2898
SN DIMAS (1965)	994.013	CS MON IN WELL 8IN DN 40FT WLY APPROX C/L INT WALNUT AVE + PUDDINGSTONE DR MKD (CO ENGR RE 5869 PI-1) 7FT NLY OF EDGE PVMT	BG	2899
SN DIMAS (1965)	1006.114	CS MON IN WELL 8IN DN 200FT ELY APPROX C/L INT WALNUT AVE + PUDDINGSTONE DR 6FT NLY EDGE PVMT MKD (CO ENGR RE 5869 PI)	BG	2900
SN DIMAS (1965)	984.378	FC BR CAP IN CONC BRIDGE NO 557 PUDDINGSTONE CHANNEL 20FT S NEW C/L PUDDINGSTONE DR 7FT E/O BRIDGE 3.4MI W TONNER AVE MKD (LA CO FLOOD CONT DIST BM 94-21)	BG	2901
SN DIMAS (1965)	984.739	COE BR DISC FLUSH IN CONC BR NO 8-557 PUDDINGSTONE CHANNEL 13FT N NEW C/L PUDDINGSTONE DR + 7FT E C/L OF BR 0.4MI W TONNER AVE MKD (LO-100 1960)	BG	2902
SN DIMAS (1965)	983.558	CS MON IN WELL 6IN DN 1FT N C/L PUDDINGSTONE DR 0.2MI WLY TONNER AVE MKD (PI 6 RE 63)	BG	2903
SN DIMAS (1965)	993.674	CS TAG W BRAD IN CONC FTG ON 2IN IP 19FT WLY + 35FT SLY C/L INT PUDDINGSTONE DR + TONNER AVE	BG	2904
SN DIMAS (1965)	993.618	CS MON IN WELL 12IN DN @ C/L INT PUDDINGSTONE DR + TONNER AVE MKD (PI 7 RE 63)	BG	2905
SN DIMAS (1965)	1011.610	CS MON IN WELL C/L TONNER AVE 6IN DN 0.2MI N C/L PUDDINGSTONE DR MKD (CO SUR RE 63)	BG	2906
SN DIMAS (1965)	1040.457	COE BR DISC IN CB 36FT N C/L BONITA AVE + 10FT W RR TRACK MKD (MC 108)	BG	2907
SN DIMAS (1965)	1044.130	COE BR DISC IN CB NW COR FIREY AVE + FIFTH ST 25FT N + 85FT W C/L INT MKD (MC 110)	BG	2908
SN DIMAS (1965)	1074.154	L+T HDWL FIREY AVE + FIFTH ST SE TIE TO RD TAG CONST C/L + 0.4MI N	BG	2909
SN DIMAS (1965)	1072.624	RD TAG ON CONST C/L FIREY AVE + FIFTH ST PAINTED (CONST C/L) 1/2 MI N C/L FIFTH ST PP 150802E	BG	2910
SN DIMAS (1965)	1079.823	COE BR MON 4IN UP FIREY AVE 0.6MI N FIFTH ST @ ANG PT N LINE 4 FT CH LNK FENCE MKD (MC 115)	BG	2911
SN DIMAS (1965)	1123.607	BR MON IN 1FT SQ CONC POST IN UP SW COR FOOT-HILL BLVD + FIREY AVE 41FT 6IN 16FT W C/L INT MKD (METP WATER DIST BM 1933)	BG	2912
SN DIMAS (1965)	1124.490	COE BR DISC N CB FOOT HILL BLVD 36FT N C/L + 75FT E C/L FIREY AVE MKD (MC 110 1961)	BG	2913
SN DIMAS (1965)	1122.749	USC+GS BR DISC FL IN CONC FOOT HILL BLVD 40FT S C/L FOOTHILL BLVD + 0.2MI E GRANT AVE MKD (P 1149 1961)	BG	2914

QUAD-YEAR	ELEV	DESCRIPTION (INCLUDE QUAD AND YEAR IN DESCRIPTION)	BM NUMBER
SN DIMAS (1965)	930.265	RDBM TAG SW COR BR ON NW COR AMELIA AVE + BASE- LINE RD 50FT N + 15FT W APPROX C/L INT	BG 2915
SN DIMAS (1965)	930.446	CS MON FL NE COR BR ON NE COR AMELIA AVE + BASE- LINE RD 75FT N + 20FT E C/L INT MKD (BM 40-2A 1964)	BG 2916
SN DIMAS (1965)	953.066	CS MON IN WELL 8IN DN ON OLD C/L AMELIA AVE 75FT S C/L FOOTHILL BLVD MKD (BM 40-3A 1963)	BG 2917
SN DIMAS (1965)	957.341	L+BN N CB COUNTRY CLUB DR 18FT N C/L + 22FT W C/L PROD AMELIA AVE NR CB MKD (BM)	BG 2918
SN DIMAS (1965)	954.659	L+BN S CB 1FT W BCR @ SW COR <b>OUT</b> AVE + COUNTR CLUB DR 18FT S + 30FT W APPROX C/L INT MKD (BM)	BG 2919
SN DIMAS (1965)	981.055	CS MON IN WELL 8IN DN C/L INT FOOTHILL BLVD AMEL IA AVE + OAK PARK RD	BG 2920
SN DIMAS (1965)	985.288	USC+GS MON 6IN UP 22FT N C/L FOOTHILL BLVD + 3FT W C/L AMELIA AVE PROD MKD (S 62 1923)	BG 2921
SN DIMAS (1965)	904.305	FC MON FL N HDWL CONC DRAIN 40FT N C/L FOOTHILL BLVD + LONE HILL RD MKD (BM 82-105) PAINTED 40-5	BG 2922
SN DIMAS (1965)	903.105	CS MON IN WELL 8IN DN C/L FOOTHILL BLVD + @ INT OF OLD LONE HILL RD MKD (RE 63)	BG 2923
SN DIMAS (1965)	1063.277	L+BN CTR HDWL 38FT S C/L <b>OUT</b> HILL BLVD + 45FT E C/L SAN DIMAS CYN RD MKD (BM 82-105)	BG 2924
SN DIMAS (1965)	1063.847	RDBM TAG CTR N HDWL 38FT N C/L FOOTHILL BLVD + 50FT E C/L SAN DIMAS CYN RD	BG 2925
SN DIMAS (1965)	1111.670	CS MON IN WELL 8IN DN @ PI OF BASELINE RD 140FT NLY C/L FOOTHILL BLVD	BG 2926
SN DIMAS (1965)	1093.456	FC MON FL SELY COR SAN DIMAS <b>OUT</b> + RAMOLA AVE 44FT ELY + 25FT SLY C/L INT MKD (BM 82-105 RW 179)	BG 2927
SN DIMAS (1965)	1407.527	LS TAG 2870 N CB 3.3FT W BCR @ NW COR GOLDEN HILLS RD + WHEELER + LA VERNE RD 27FT N + 37FT W C/L INT	BG 2928
SN DIMAS (1965)	1324.573	CS MON 4IN UP IN 12IN CONC POST 48FT E C/L WHEEL ER + LA VERNE RD + 1.2MI N BASELINE RD NR SW COR TOWER NO 232-D4 MKD (BM 53-3 1958)	BG 2929
SN DIMAS (1965)	1297.859	CS MON 2IN DN ON E FENCE <b>OUT</b> FIRE STA NO 104 36FT N C/L WHEELER + LA VERNE RD 0.6MI N ALDERS- GATE RD MKD (LOT COR)	BG 2930
SN DIMAS (1965)	1291.276	CS MON IN CONC POST FL NLY C/L PROD WHEELER + LA VERNE RD 0.9 MI N BASELINE RD NR CO FIRE STA NO 104 MKD (RPPI 25.00)	BG 2931
SN DIMAS (1965)	1151.571	RDBM TAG E END CB 20FT N C/L BASELINE RD + 1300 FT W WHEELER + LA VERNE RD	BG 2932
SN DIMAS (1965)	1150.762	RAMSET N CB OF CB 20FT N <b>OUT</b> BASELINE RD + 1500 FT W WHEELER + LA VERNE RD	BG 2933
SN DIMAS (1965)	1159.939	L+BRAD W WING WL OF BR NO BR <b>OUT</b> 31FT N C/L BASELINE RD + 350 FT E EMERALD AVE	BG 2934
SN DIMAS (1965)	1060.134	L+PK E CB 1FT S BCR @ SE COR JUANITA AVE + GRAND AVE 46FT S + 30FT E C/L INT	BG 2935

QUAD-YEAR	ELEV	DESCRIPTION (INCLUDE QUAD AND YEAR IN DESCRIPTION)	BM NUMBER
SN DIMAS (1965)	1064.283	CS MON IN WELL 8IN DN @ C/L INT GLADSTONE ST + RAMONA AVE MKD (RE 2177)	BG 2936
SN DIMAS (1965)	1065.230	L+PK W CB 1FT N BCR @ NW COR GLADSTONE ST + RAMONA AVE 47FT N + 16FT W C/L INT	BG 2937
SN DIMAS (1965)	1061.694	FC MON FL @ NW COR BR NO B 561 20FT N C/L GLADSTONE ST + 500FT W RAMONA AVE MKD (BM 95-6)	BG 2938
SN DIMAS (1965)	1065.161	L+T CONC WK TO HSE SE COR GLADSTONE ST + SAN DIMAS CYN RD 27FT S + 60FT E C/L INT	BG 2939
SN DIMAS (1965)	1063.772	CS MON IN WELL 16IN DN @ C/L INT GLADSTONE ST + SAN DIMAS CYN RD MKD (RE 2177)	BG 2940
SN DIMAS (1965)	1018.461	CS MON IN WELL 14IN DN @ C/L INT GLADSTONE ST + WALNUT AVE MKD (RE 329)	BG 2941
SN DIMAS (1965)	1019.952	RDBM TAG S CB 1FT W BCR @ SW COR GLADSTONE ST + WALNUT AVE 36FT S + 60FT W C/L INT	BG 2942
SN DIMAS (1965)	1011.331	L+BRAD E CB @ BCR @ SE COR GLADSTONE ST + SAN DIMAS AVE 27FT S + 25FT E C/L INT	BG 2943
SN DIMAS (1965)	730.595	L+T E CB 3FT N BCR @ NE COR CYPRESS AVE + SUNFLOWER AVE 63FT N + 42FT E C/L INT	BG 2944
SN DIMAS (1965)	696.155	L+T S CB CYPRESS ST 30FT S C/L @ C/L PROD BONNIE COVE AVE @ E END DROP INLET	BG 2945
SN DIMAS (1965)	708.860	CS MON IN WELL 8IN DN @ C/L INT BONNIE COVE AVE + COVINA BLVD MKD (CO F-1 RE 63)	BG 2946
SN DIMAS (1965)	710.308	CS TAG N CB @ NE COR BONNIE COVE AVE + COVINA BLVD 30FT N + 60FT E C/L INT	BG 2947
SN DIMAS (1965)	636.960	RDBM TAG S CB 1FT E BCR @ SW COR GRAND AVE + COVINA BLVD 100FT W + 30FT S C/L INT	BG 2948
SN DIMAS (1965)	628.130	RDBM TAG E CB 1FT S BCR @ NE COR CYPRESS ST + GRAND AVE 64FT N + 40FT E C/L INT	BG 2949
SN DIMAS (1965)	660.164	L+T E CB 0.2FT N BCR @ SE COR GRAND AVE + JUANITA AVE 60FT S + 60FT E C/L INT	BG 2950
SN DIMAS (1965)	661.206	BM TAG IN LEAD NE COR GRAND AVE + JUANITA AVE 46FT N + 90FT E C/L INT	BG 2951
SN DIMAS (1965)	671.294	RDBM TAG S CB 1FT N BCR @ SE COR GRAND AVE + BASELINE RD 64FT S + 40FT E C/L INT	BG 2952
SN DIMAS (1965)	701.863	RD HD SPK N CB 5FT E BCR @ NE COR GRAND AVE + ALOSTA AVE 30FT N + 40FT E C/L INT @ W END C B	BG 2953
BASELINE (1965)	823.718	CS MON IN WELL 8IN DN SW COR 2ND ST + OAK AVE 31FT S + 50FT W C/L INT MKD (BM 11-84A 1962)	BG 2955
BASELINE (1965)	850.571	CS MON FL IN HDWL 27FT S C/L FIRST ST + 84FT W C/L WHITE AVE MKD (BM 11-83A 1962)	BG 2956
SN DIMAS (1965)	591.582	CS MON IN WELL 8IN DN 4FT SLY APPROX C/L PVMT PUENTE RD + 0.3MI SLY INT REEDER AVE + BADILLO ST MKD (ANGLE PT)	BG 2957
SN DIMAS (1965)	669.112	L+BN CONC FTG 5FT CH LNK FEN @ WLY COR 30FT NLY APPROX C/L PVMT MESARICA AVE + 130FT ELY APPROX C/L PUENTE ST MKD (BM)	BG 2958

QUAD-YEAR	ELEV	DESCRIPTION (INCLUDE QUAD AND YEAR IN DESCRIPTION)	BM NUMBER
SN DIMAS (1965)	699.693	L+T WLY CONC DR TO HSE 20827 MESARICA AVE 20FT NLY APPROX C/L + ABT 0.7MI SLY INT BADILLO ST + REEDER AVE MKD (BM)	BG 2959
SN DIMAS (1965)	717.456	L+T CONC WK TO HSE SELY COR CLOVERLAND DR + MESARICA AVE 90FT SLY + 25FT ELY APPROX C/L INT MKD (BM)	BG 2960
SN DIMAS (1965)	716.116	L+T CONC APRON OF DRWY TO HSE 21025 CLOVERLAND DR 17FT ELY APPROX C/L 18FT NLY WOODHURST MKD(BM)	BG 2961
SN DIMAS (1965)	1023.692	RDBM TAG S CB 6FT E BCR @ SW COR PALM DR + LIVE OAK AVE 18FT S + 45FT W C/L INT	BG 2962
SN DIMAS (1965)	1008.678	RDBM TAG S CB PALM DR 20FT S C/L NR CTR CONC CHANNEL 1200FT E LIVE OAK AVE	BG 2963
SN DIMAS (1965)	955.783	METROPOLITAN WATER BM MON <b>OUT</b> NW COR SIERRA MADRE AVE + LORRAIN AVE 25FT N + 15FT W C/L INT MKD (51 H)	BG 2964
SN DIMAS (1965)	1002.624	RDBM TAG N CB 3FT W BCR @ NW COR SIERRA MADRE AVE + GLENDORA MT RD 30FT N + 63FT W APPROX C/L INT	BG 2965
SN DIMAS (1965)	850.430	RDBM TAG E CB 1FT N BCR @ NE COR VALLEY CENTER AVE + PALOPINTO ST 44FT N + 30FT E APPROX C/L INT	BG 2966
SN DIMAS (1965)	847.434	RDBM TAG W CB 5FT N BCR @ NW COR VALLEY CENTER AVE + LAWFORD PL 65FT N + 30FT W C/L INT	BG 2967
SN DIMAS (1965)	818.693	L+NAIL W END BRIDGE NO <b>OUT</b> 53 TO 54FT N C/L ALOSTA AVE NR PROD OF VALLEY CENTER AVE	BG 2968
SN DIMAS (1965)	818.725	RD HD SPK S CB BRIDGE NO <b>OUT</b> 53 TO 54 36FT S C/L ALOSTA AVE NR PROD VALLEY CENTER AVE	BG 2969
SN DIMAS (1965)	760.932	USC+GS MON N CB 3FT W BCR @ NW COR GLADSTONE ST + STEPHORA AVE 33FT N + 63FT W C/L INT MKD (V 924)	BG 2970
SN DIMAS (1965)	753.225	L+BN N CB 20FT E BCR @ NE COR GLADSTONE ST + BONNIE COVE AVE 30FT N + 85FT E C/L INT E END CB MKD (BM)	BG 2971
SN DIMAS (1965)	751.769	RDBM TAG E CB 1FT N BCR @ NE COR GLADSTONE ST + BONNIE COVE AVE 67FT N + 30FT E C/L INT	BG 2972
SN DIMAS (1965)	720.446	CS MON IN WELL 8IN DN @ C/L INT BONNIE COVE AVE + CIENEGA AVE MKD (CO ENG RE 5869) USE EDGE ON R	BG 2973
SN DIMAS (1965)	705.846	PK+L NR MCR @ NW COR RUDDOCK ST + LYMAN AVE 23FT N + 33FT W C/L INT NR FIRE HYD MKD (BM)	BG 2974
BASELINE (1965)	617.096	CS MON FLUSH IN WK ON SW COR ALOSTA AVE + CITRUS AVE 63FT S + 43FT W C/L INT MKD (BM 40-12B)	BG 2975
SN DIMAS (1965)	781.928	RDBM TAG N CB 1FT W BCR @ NW COR VALLEY CENTER AVE + COVINA BLVD 30FT N + 76FT W C/L INT	BG 2976